

# Stephen C. Gault Co.

## FOR SALE 52,700 SF CRANE-SERVED INDUSTRIAL FACILITY

1109 SOUTH PRESTON

LOUISVILLE, KENTUCKY



- 5,625 SF Office on second floor
- 7.5 and 5 Ton Cranes
- Sprinkler
- 1.758 Acres—Zoned C-2
- 47 Car Paved Parking

- 20.5' - 23' Clear Heights
- Interior Dock and Drive-In Loading  
(2) Docks (2) Drive-Ins (16'W x 14'H)
- Located 1 Block East of I-65
- Brick over Block Construction
- Heavy Electrical

For More Information Contact:

**Stephen C. Gault Co.** 

STEVE GAULT  
scg@scgault.com  
(502) 451-1122

DALTON DREISBACH  
dalton@scgault.com  
(502) 451-1122

*This information was obtained from sources deemed reliable, but its accuracy is not guaranteed.*

# FOR SALE

## 52,700 SF CRANE-SERVED INDUSTRIAL FACILITY

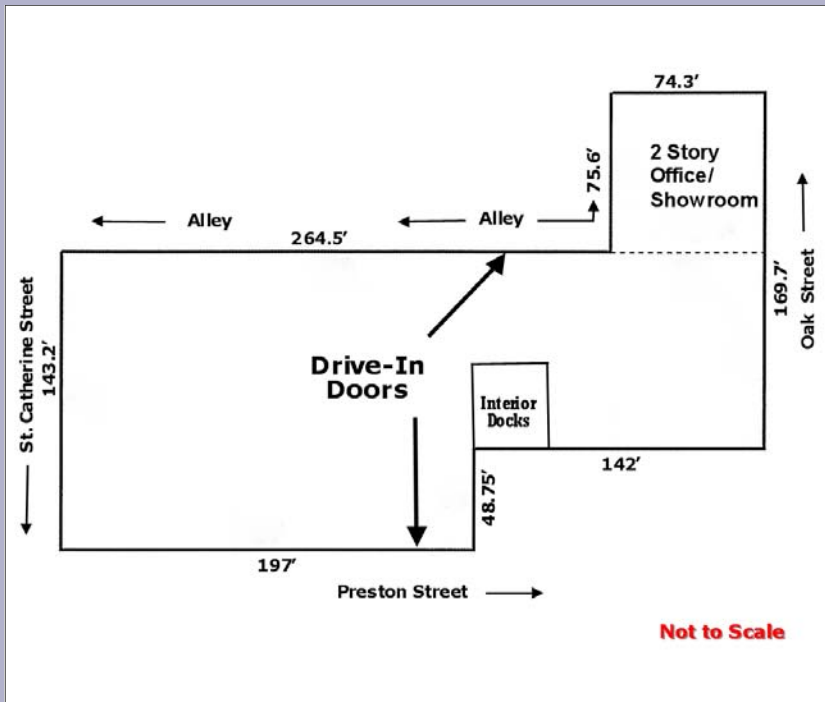

### 1109 SOUTH PRESTON

For More Information Contact:

STEVE GAULT  
scg@scgault.com  
(502) 451-1122

DALTON DREISBACH  
dalton@scgault.com  
(502) 451-1122

**Stephen C. Gault Co.**